

CERTIFICATE OF LOCATION OF GOVERNMENT CORNER

CENTER _____ of Section 9, Township 108, Range 41, 5TH P.M.

STATE OF MINNESOTA, County of MURRAY

At the corner location shown on the sketch:

On 09-06-2017 found a STONE.

left monument as found, lowered monument, removed monument (explain)

On 09-06-2017 placed a 5/8" IRON WITH SEAL #43844 ON NORTH SIDE OF STONE.

SKETCH OF REFERENCE TIES

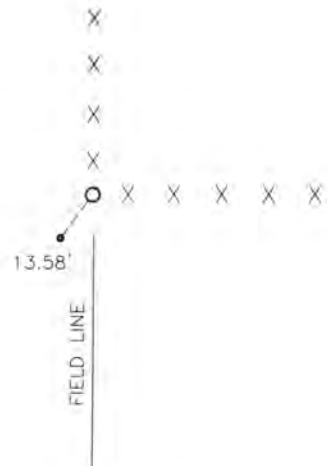

Minnesota State Plane Coordinate
System Murray County Datum
NAD83 (1996)
N: 218965.024
E: 498040.835

T-bar with seal #12237 SW 13.58'

Statement of evidence relative to this corner location is on back of page.

I hereby certify that this document and the data contained herein was prepared by me or under my direct supervision

[Signature] 2/20/18
SIGNATURE DATE

Registration No. 43844

- Land Surveyor, Professional Engineer
 County Surveyor, County Engineer

STATE OF MINNESOTA, } ss.
COUNTY OF MURRAY, }

I hereby certify that the within Instrument was filed in this office for record on the 26TH day of MARCH A.D. 20 18 at 9:00 o'clock A. M., and was duly recorded as Document No. _____

[Signature]
County Recorder

Statement of Evidence

In 1861, L.G.M. Fletcher did the original subdivision of the township.

On May 1, 1931, County Surveyor, a stone was found on the north side of an 8" corner fence post.

On February 5, 1934, F.A. March, found a stone on the north side of an 8" corner fence post with 2 other stone above it.

On September 30, 1974, (No name) a large field stone was found at the center of Section 9-108-41.

On May 30, 2002, Gerald Vickerman found a stone at the center of Section 9-108-41. He did not accept the stone and set an iron T-bar with seal #12237 using a mathematical calculation. It is 4.52' west and 12.80' south of the stone.

On September 6, 2017, Bueltel-Moseng Land Surveying found a T-bar with seal #11237 and a stone using the distances recorded by Vickerman. We did not accept the T-bar as the corner and held to the location of the stone as the center of Section 9-108-41. The stone is at the corner of the occupation lines to the north, south, and east. There is no occupation line to the west. We set a 5/8" iron with seal #43844 on the north side of the stone.